

# POTENTIAL SCENARIO A

NOT A PROPOSAL. FOR DISCUSSION PURPOSES ONLY.

- 1) Riding Arena
- 2) Livery Stable
- 3) Paddocks (15x24)
- 4) Paddocks (15x30)
- 5) Paddocks (15x40)
- 6) Paddocks (15x30)
- 7) Pastures (5 areas)
- 8) Composting Station
- 9) Maintenance + Storage
- 10) Trailer Parking
- 11) Hay Barn
- 12) Visitor/Learning Center
- 13) Groundskeeper House
- 14) Farm Animals Barn
- 15) Visitor Parking
- 16) Restored Landscape (no horse access)
- 17) Overlook
- 18) Pavilion

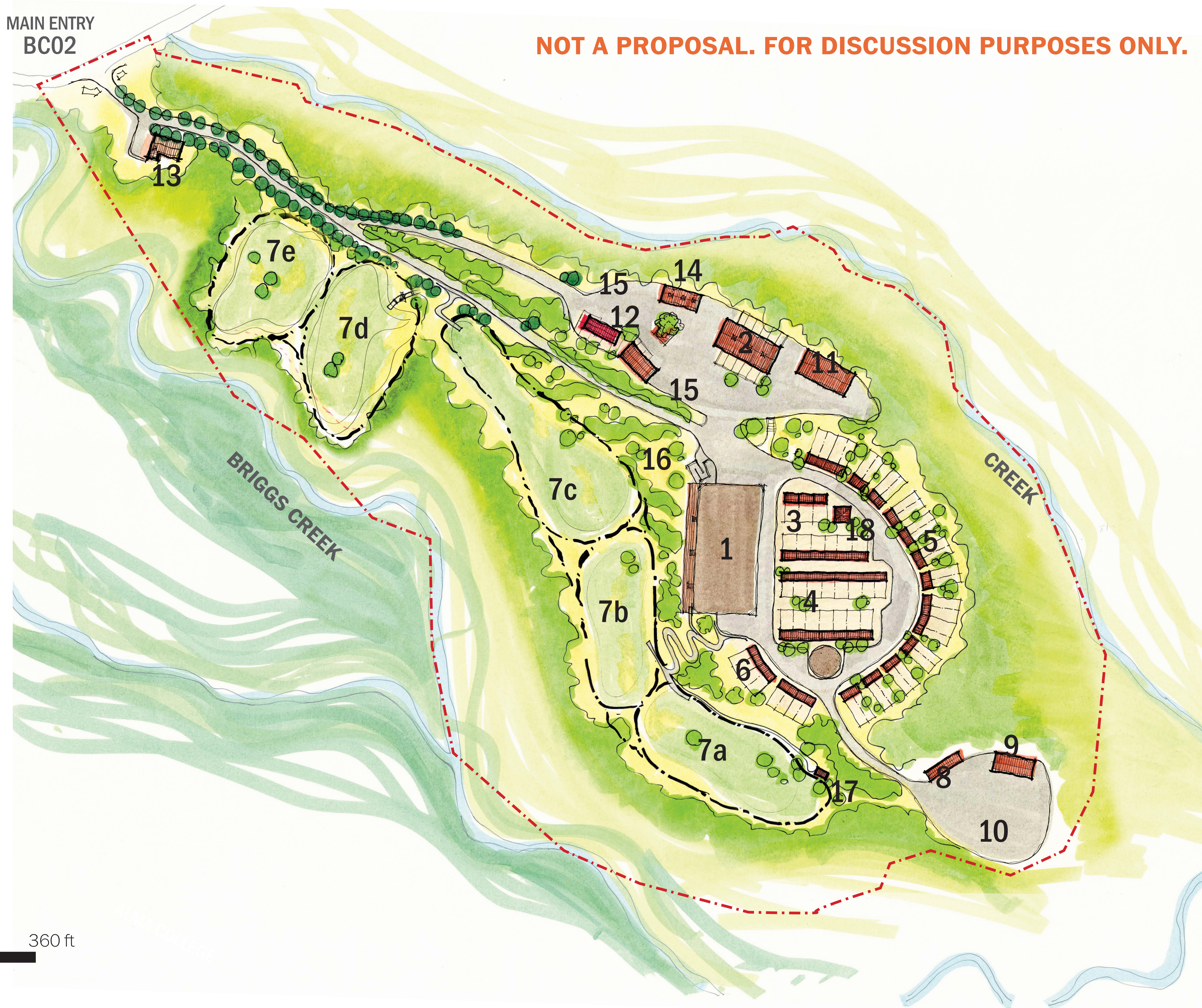

## PROGRAM ELEMENTS

- Boarding for up to 72 horses (60 paddocks + 12 in livery)
- 1 Arena (open)
- 5 Pasture areas
- Parking (cars and trailers)
- Public program facilities (visitor center, trails) reusing 1 old structure
- Caretaker residence
- Storage + composting facilities





# POTENTIAL SCENARIO B

NOT A PROPOSAL. FOR DISCUSSION PURPOSES ONLY.



- 1) Riding Arena
- 2) Covered Arena
- 3) Paddocks (15x30)
- 4) Paddocks (15x40)
- 5) Central Paddocks
- 6) Pastures (5 areas)
- 7) Hay Barn
- 8) Composting Station
- 9) Maintenance + Storage
- 10) Trailer Parking
- 11) Visitor/Learning Center
- 12) Groundskeeper House
- 13) Visitor Parking
- 14) Restored Landscape (no horse access)
- 15) Pavilion

## PROGRAM ELEMENTS

- Boarding for up to 60 horses
- 2 Arenas (1 open + 1 covered)
- 5 Pasture areas
- Parking (cars and trailers)
- Public program facilities (visitor center, trails) reusing 2 old structures
- Caretaker residence
- Storage + composting facilities





# POTENTIAL SCENARIO C

NOT A PROPOSAL. FOR DISCUSSION PURPOSES ONLY.

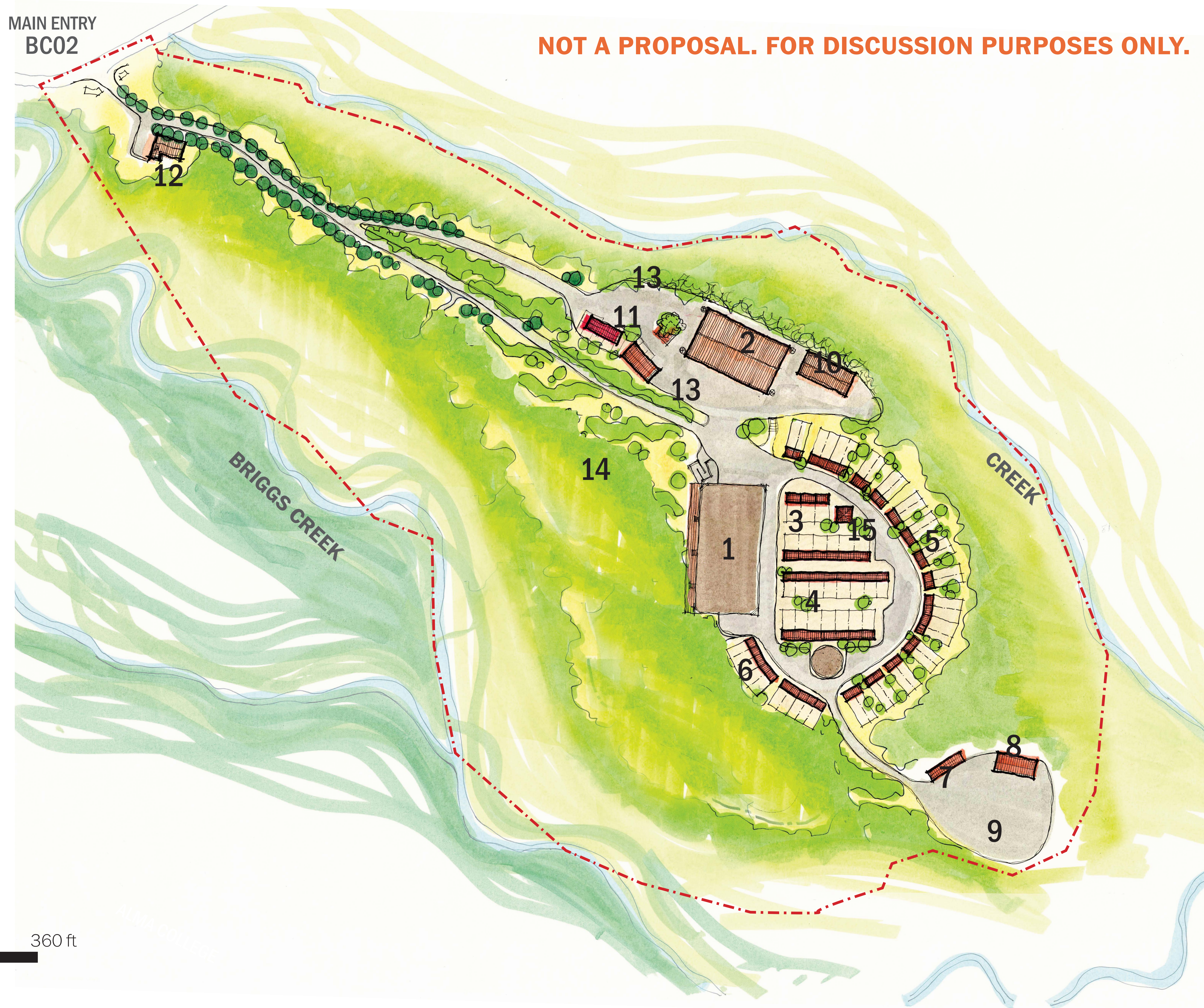

- 1) Riding Arena
- 2) Covered Arena
- 3) Paddocks (15x24)
- 4) Paddocks (15x30)
- 5) Paddocks (15x40)
- 6) Paddocks (15x30)
- 7) Composting Station
- 8) Maintenance + Storage
- 9) Trailer Parking
- 10) Hay Barn
- 11) Visitor/Learning Center
- 12) Groundskeeper House
- 13) Visitor Parking
- 14) Restored Landscape (no horse access)
- 15) Pavilion

## PROGRAM ELEMENTS

- Boarding for up to 64 horses
- 2 Arenas (1 open + 1 covered)
- No Pasture areas
- Parking (cars and trailers)
- Public program facilities (visitor center, trails) reusing 1 old structure
- Caretaker residence
- Storage + composting facilities

